

# Matrix Rotary Seal

## Easy-to-Install Patented Split Rotary Seal for Worn Shaft Applications

The Chesterton® patented Matrix Rotary Seal is a split bearing seal developed to work on worn equipment and large run-out shafts. This unique seal protects pumps, gearboxes, and other rotating equipment.

The innovative split design eliminates the need for equipment disassembly and minimizes equipment downtime to ensure optimal continuous operation of critical equipment.

This product is a robust, maintenance-friendly, easy-to-install solution to address equipment with:

- Worn Shafts/Sleeves
- High Vibration
- Large Run-Out
- Blind Installations

### Targeted Applications

Pumps, gearboxes, conveyors, motors, and fans

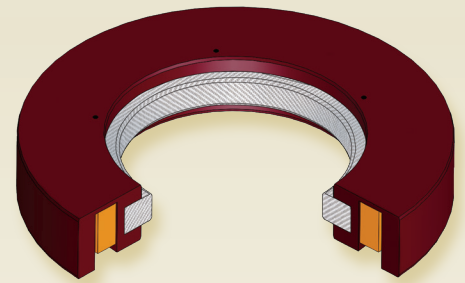
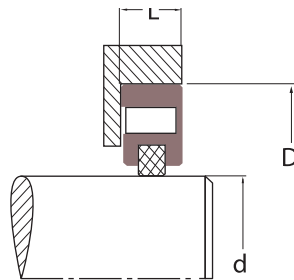

- Engineered for large runout and worn equipment
- Eliminates cumbersome equipment teardown and minimizes downtime
- Excludes external contamination, preserves internal lubrication
- Flexible design provides ease of installation
- Manufactured to custom equipment dimensions and requirements
- Covers all industries including steel, mining, paper, and agricultural

### SPECIFICATIONS

Seal Housing	Sealing Element	Shaft Size Range mm (Inch)	Temperature °C (°F)	Speed m/s (ft/min)	Pressure bar (psi)	Eccentricity mm (Inch)	Chemical Resistance
AWC800	1727NP	50 – 762 (2 – 30)	85 (185)	15 (3000)	0.3 (5)	up to 1,5 (0.060)	Compatible with all commonly used bearing and gear box oils and greases
AWC860	1727NP	50 – 762 (2 – 30)	120 (250)	15 (3000)	0.3 (5)	up to 1,5 (0.060)	

### Common Seal Profiles



Matrix

## Design and Function

The innovative unitized design combines Chesterton's leading polyurethane and impregnated synthetic fiber packing technology to maximize seal performance and reliability.

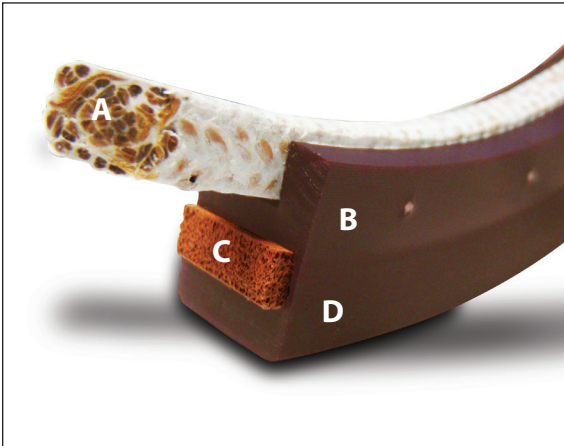

- A. Compression Packing** – Impregnated synthetic fiber creates a seal against rotating shaft
- B. Nylon Pins** – Prevents rotation of compression packing
- C. Energizer** – Closed cell foam energizes compression packing against the shaft to help create a seal
- D. Polymer Housing** – Durable, flexible material unitizes the seal assembly and energizes the sealing element

## Split Seal Design for Easy and Quick Installation

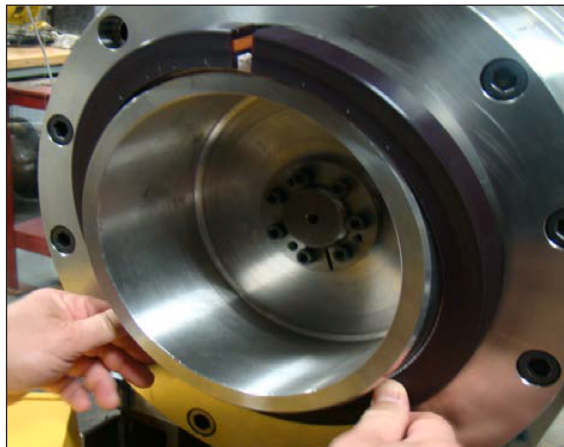

Chesterton ISO certificates available on [chesterton.com/corporate/iso](http://chesterton.com/corporate/iso)

Technical data reflects results of laboratory tests and is intended to indicate general characteristics only. A.W. Chesterton Company disclaims all warranties express or implied, including warranties of merchantability and fitness for a particular purpose. Liability, if any, is limited to product replacement only. Any images contained herein are for general illustrative or aesthetic purposes only and are not intended to convey any instructional, safety, handling or usage information or advice respecting any product or equipment. Please refer to relevant Safety Data Sheets, Product Data Sheets, and/or Product Labels for safe use, storage, handling, and disposal of products, or consult with your local Chesterton sales representative.

© 2020 A.W. Chesterton Company.  
® Registered trademark owned by A.W. Chesterton Company in USA and other countries, unless otherwise noted.

Distributed by: